

Transmission Housing, Replace

1. Illustration of transmission housing
 1. Transmission housing

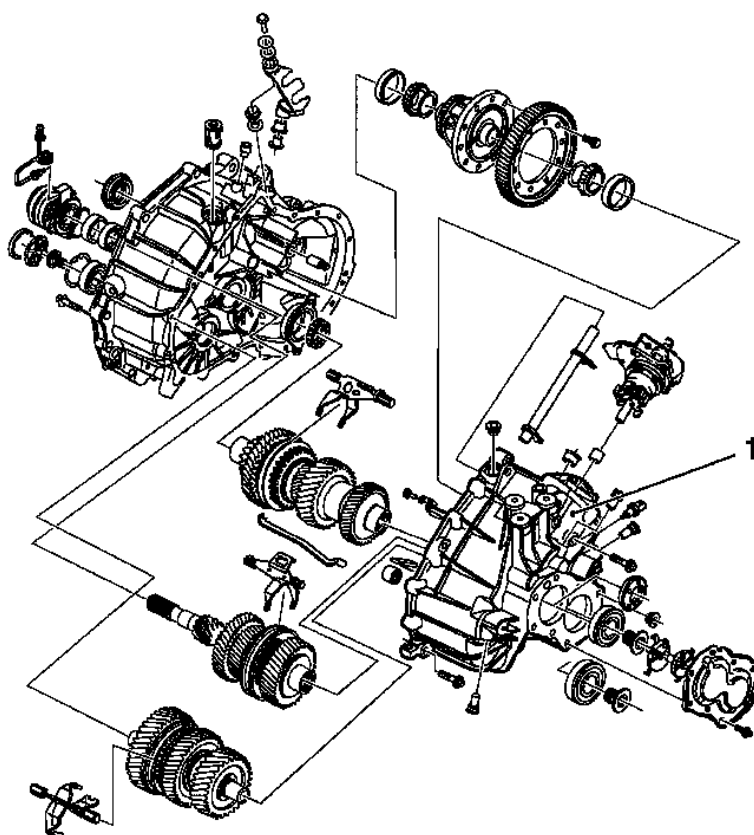

L 2630

2. Remove transmission from vehicle - see operation "Transmission, Remove and Install".
3. Disassemble transmission - see operation "Transmission, Seal Completely".
4. Remove bearing for main (2) and drive shaft (3) - see operation "Bearings, Main Shaft and / or Drive Shaft in Transmission Housing, Replace"
5. Remove tapered roller bearing outer race for differential (1) - see operation "Tapered Roller Bearing, Differential, Replace"

Note: Press sleeves, which are pressed into transmission housing, are not available as individual parts, but are already installed in new transmission housing
6. Install tapered roller bearing outer race for differential (1) - see operation "Tapered Roller Bearing, Differential, Replace"

7. Install bearing for main (2) and drive shaft (3) - see operation "Bearings, Main Shaft and / or Drive Shaft in Transmission Housing, Replace"

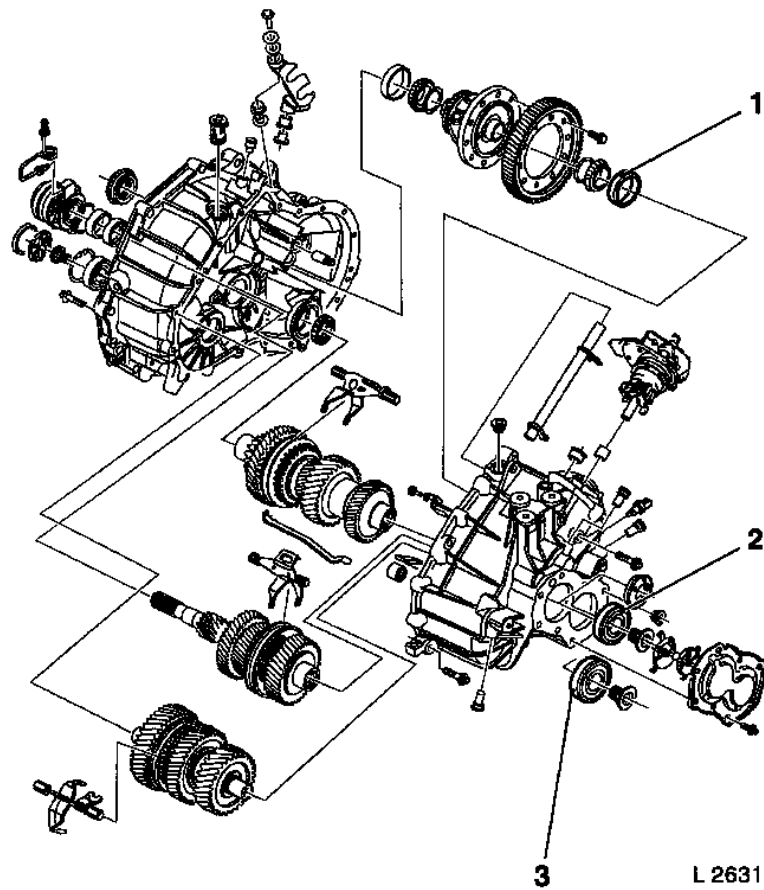

8. Assemble transmission - see operation "Transmission, Seal Completely"
9. Install transmission into vehicle- see operation "Transmission, Remove and Install"